

Standing Seam Clips

Engineered panel clips
For standing seam panel attachments

- Engineered panel clips are custom designed and manufactured for your panel system.
- Clips are supplied in galvanized steel, coated steel, stainless steel and other materials.
- Engineered fixed and float clip designs are available.

- Standard clips are available from stock without tooling cost to you.
- Sealant can be pre-applied to the clips to maintain the seal at the clip attachment.
- Clip design options are available for review and evaluation.
- All clips also available in stainless steel.

Application - Snap Lock

Snap Lock Panel Design

Configurations require very low profile clip bases with a base feature to hold the panel above the low profile fastener heads.

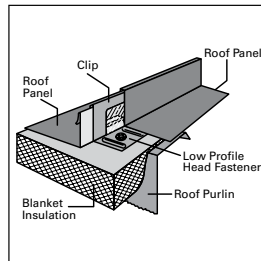

Fixed Clips are primarily used with these panels. Low profile head fasteners should be used with these panels to provide clearance for the panel over the fastener heads. These clips are manufactured from steel, stainless steel and other materials with various finishes to fit the needs of the panel application.

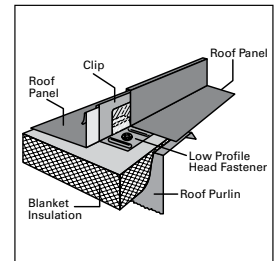

Selection

1" Snap Lock Clip

G90 Galvanized: 18 ga.
Packaged 200 per carton

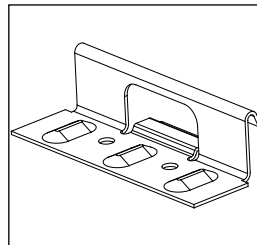

1-1/2" Snap Lock Clip

G90 Galvalume: 24 ga.
Packaged 1000 per carton

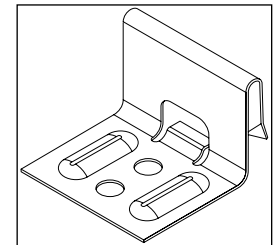

1-1/2" Snap Lock

G90 Galvanized: 18 ga. or 20 ga.
Packaged 500 per carton

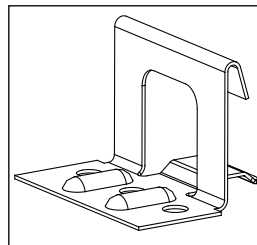

1-1/2" Snap Lock Clip

G90 Galvanized: 18 ga.
Packaged 125 per carton

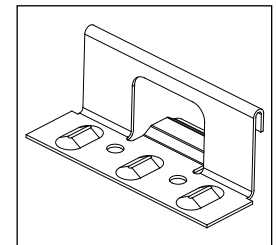

1-3/4" Snap Lock (1 hole) Clip

G90 Galvanized: 18 ga.
Packaged 500 per carton

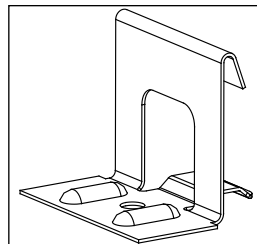

1-3/4" Snap Lock (2 hole) Clip

G90 Galvanized: 18 ga.
Packaged 250 per carton

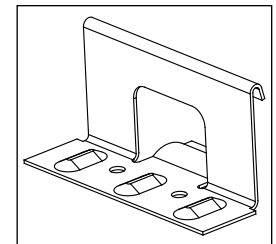

1-3/4" Snap Lock (3 hole) Clip

G90 Galvanized: 20 ga.
Packaged 500 per carton

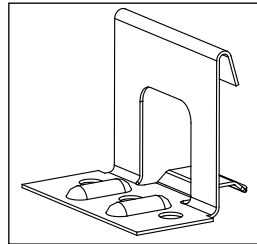

BattenTrim (spider) Clip

304SS (1/4 Hard): 22 ga.
Packaged 500 per carton

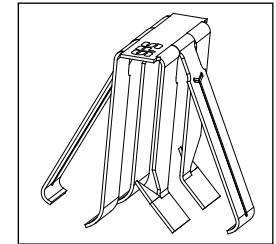

Continued on following page

Standing Seam Clips

Engineered panel clips
For standing seam panel attachments

Application - Architectural/Mechanical

Architectural/Mechanical
Panel Design

Configurations require low profile bases with clearance for the fastener head.

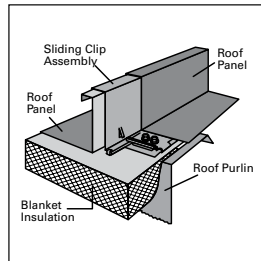

Fixed and Float Clips are used with these panels. The clips may have pre-applied sealant to maintain the panel seal at the clip attachment point. These clips are manufactured from steel, stainless steel and other materials with various finishes to fit the needs of the panel application.

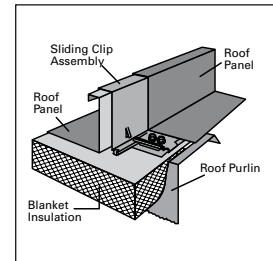

Selection

1-1/2" Fixed Clip (.38 Hor.)

G90 Galvanized: 22 ga.
Packaged 250 per carton

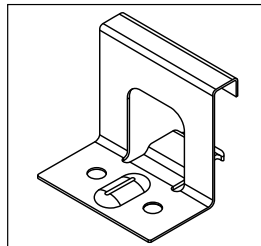

2-3/8" Fixed Clip (.70 Hor.)

G90 Galvanized: 22 ga.
Factory applied sealant
Packaged 250 per carton

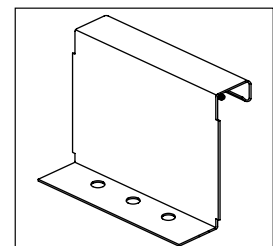

1-1/2" Fixed Clip (.43 Hor.)

G90 Galvanized: 24 ga.
Packaged 350 per carton

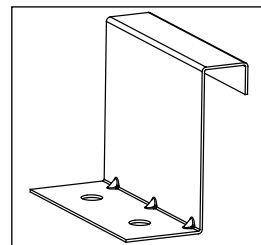

2-3/8" Fixed Clip (.70 Hor.)

G90 Galvanized: 22 ga.
Packaged 250 per carton

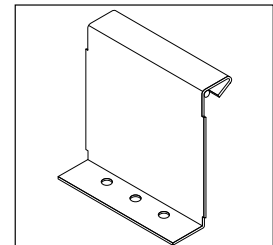

2" Fixed Clip (.70 Hor.)

G90 Galvanized: 22 ga.
Factory applied sealant
Packaged 400 per carton

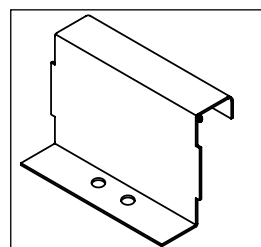

2-3/8" Fixed Clip (.66 Hor.)

G90 Galvanized: 22 ga.
Packaged 200 per carton

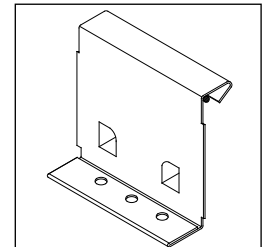

2" Fixed Clip (.57 Hor.)

G90 Galvanized: 22 ga.
Packaged 400 per carton

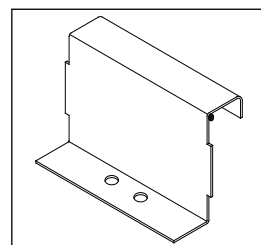

3" Fixed Clip (.70 Hor.)

G90 Galvanized: 22 ga.
Factory applied sealant
Packaged 250 per carton

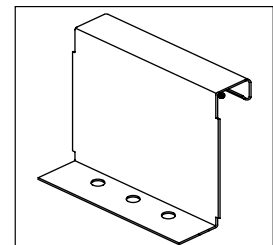

2" Fixed Clip (.70 Hor.)

G90 Galvanized: 22 ga.
Packaged 400 per carton

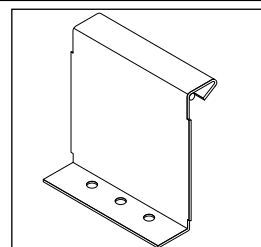

3" Fixed Clip (.935 Hor.)

G90 Galvanized: 24 ga.
Packaged 250 per carton

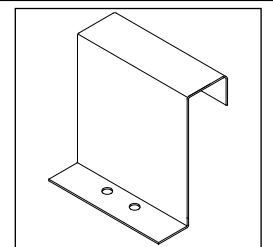

Continued on following page

Standing Seam Clips

Engineered panel clips
For standing seam panel attachments

Application - Architectural/Mechanical

3" Fixed Clip (.70 Hor.)

G90 Galvanized: 22 ga.
Packaged 250 per carton

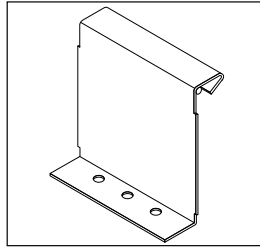

2" Float Clip (.70 Hor.)

G90 Galvanized: 22 ga. Tab
Base: 16 ga.
Factory applied sealant
Packaged 100 per carton

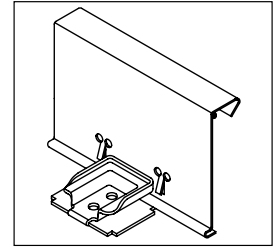

3" Fixed Clip (.66 Hor.)

G90 Galvanized: 22 ga.
Packaged 200 per carton

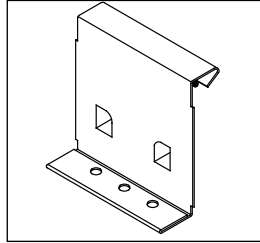

2" Float Clip (.70 Hor.)

G90 Galvanized: 22 ga. Tab
Base: 16 ga.
Factory applied sealant
Packaged 100 per carton

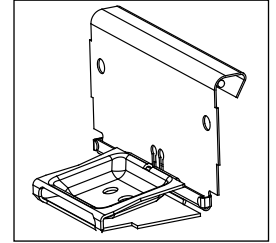

1-1/2" Float Clip (.71 Hor.)

G90 Galvanized: 22 ga. Tab
Base: 16 ga.
Packaged 100 per carton

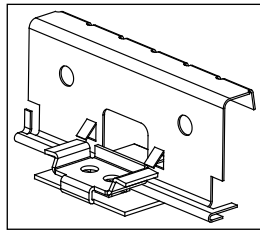

2" Float Clip (.57 Hor.)

G90 Galvanized: 22 ga. Tab
Base: 16 ga.
Packaged 80 per carton

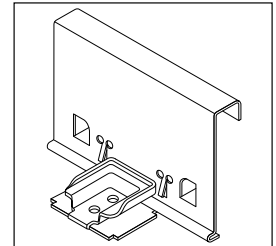

1-1/2" Float Clip (.65 Hor.)

G90 Galvanized: 22 ga. Tab
Base: 16 ga.
Factory applied sealant
Packaged 100 per carton

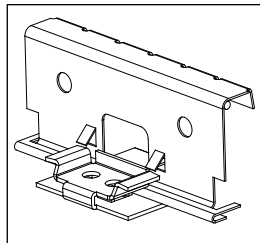

2" Float Clip (.57 Hor.)

G90 Galvanized: 22 ga. Tab
Base: 16 ga.
Packaged 100 per carton

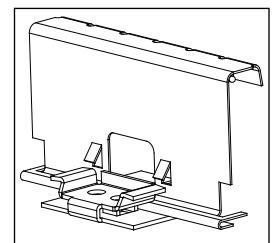

1-1/2" Float Clip (.38 Hor.)

G90 Galvanized: 22 ga. Tab
Base: 16 ga.
Packaged 80 per carton

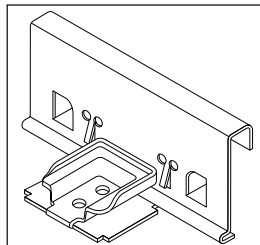

2" Float Clip (.66 Hor.)

G90 Galvanized: 22 ga. Tab
Base: 16 ga.
Factory applied sealant
Packaged 80 per carton

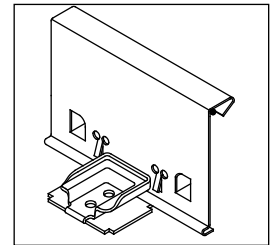

2" Float Clip (.70 Hor.)

G90 Galvanized: 22 ga. Tab
Base: 16 ga.
Factory applied sealant
Packaged 100 per carton

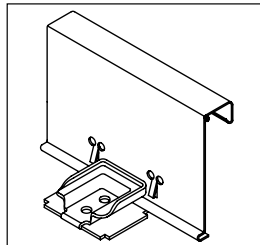

3" Float Clip (.70 Hor.)

G90 Galvanized: 22 ga. Tab
Base: 16 ga.
Factory applied sealant
Packaged 100 per carton

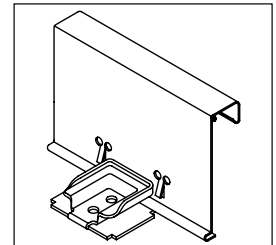

Continued on following page

Standing Seam Clips

Engineered panel clips
For standing seam panel attachments

Application - Architectural/Mechanical

3" Float Clip (.70 Hor.)

G90 Galvanized: 22 ga. Tab
Base: 16 ga.
Factory applied sealant
Packaged 100 per carton

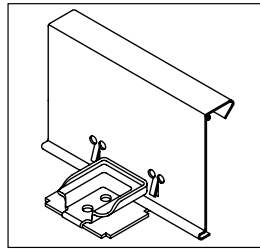

Butterfly Tab 1-1/2"

G90 Galvanized: 22 ga.
Packaged 200 per carton

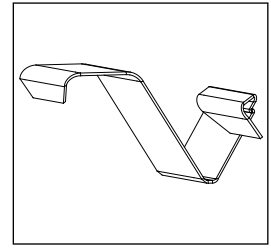

3" Float Clip (.66 Hor.)

G90 Galvanized: 22 ga. Tab
Base: 16 ga.
Factory applied sealant
Packaged 60 per carton

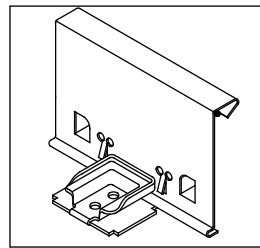

Butterfly Base 1-1/2"

G90 Galvanized: 22 ga.
Packaged 200 per carton

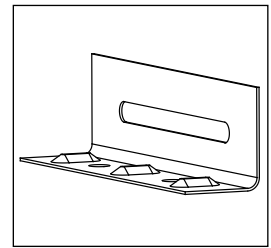

3-3/8" Float Clip (.57 Hor.)

For 2" Panel

G90 Galvanized: 22 ga. Tab
Base: 16 ga.
Packaged 70 per carton

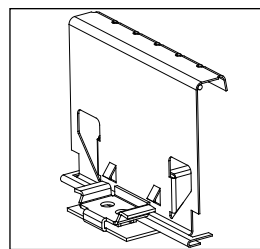

Butterfly Tab 2"

G90 Galvanized: 22 ga.
Packaged 150 per carton

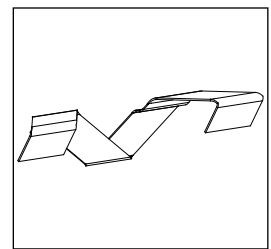

3-3/8" Float Clip (.57 Hor.)

For 3" Panel

G90 Galvanized: 22 ga. Tab
Base: 16 ga.
Packaged 80 per carton

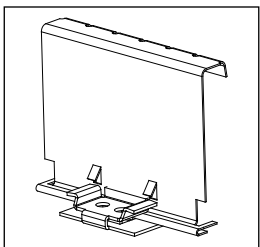

Butterfly Base 2"

G90 Galvanized: 18 ga.
Packaged 150 per carton

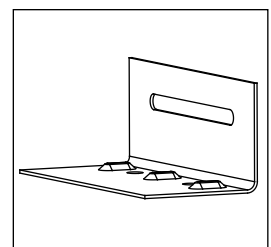

4-3/8" Float Clip (.57 Hor.)

For 3" Panel

G90 Galvanized: 22 ga. Tab
Base: 16 ga.
Packaged 80 per carton

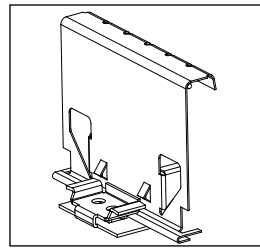

Continuous Base 1-1/2" or 2"

1-1/2"—G90 Galv.: 22 ga.
1-1/2" Packaged 125 10ft pieces per carton
2"—G90 Galv.: 18 ga.
2" Packaged 100 10ft pieces per carton

